

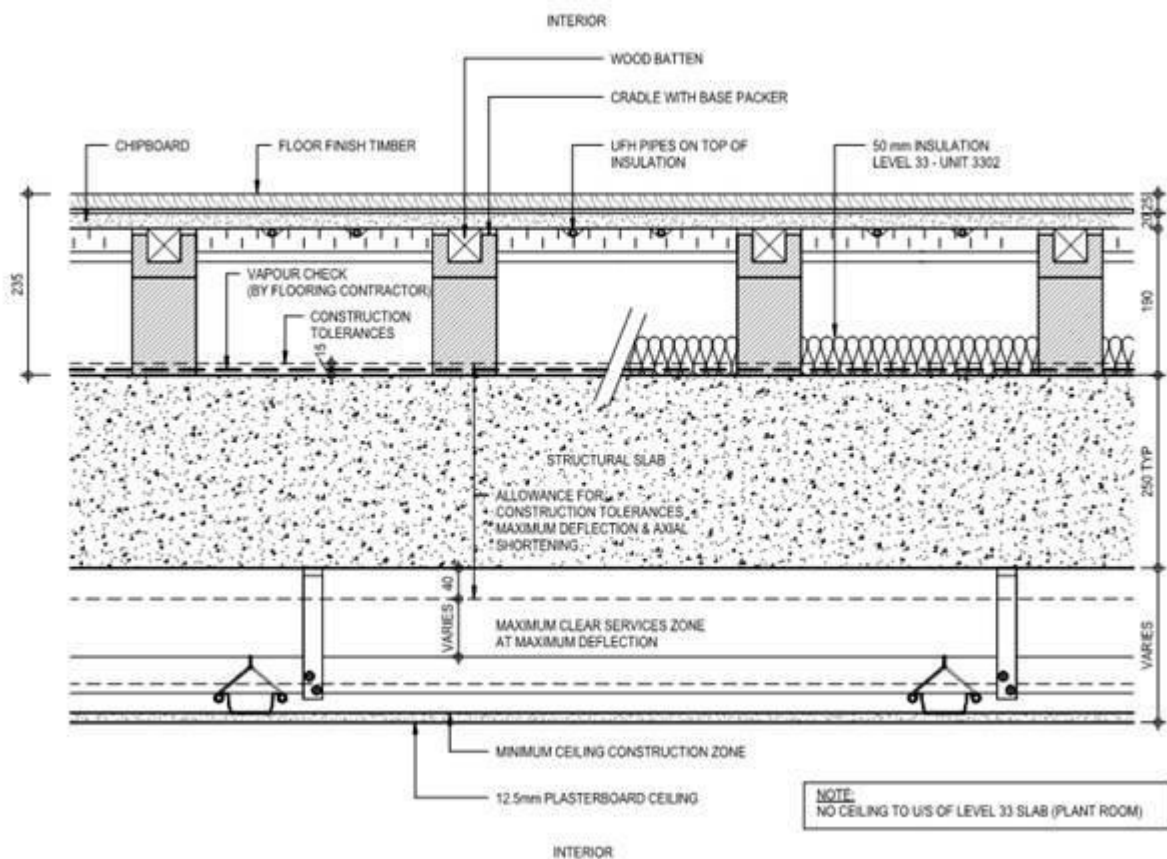

## Typical Floor Build up using Acoustic Cradle Systems with Underfloor Heating

Below is a drawing of a typical build up from the slab when using a cradle system with underfloor heating. The surface of the cradle system here is chipboard which is acceptable. A better solution would be to use cementitious board with a tongue and groove as it will disperse the heat better.

What this does not show are the spreader plates that should be used under the heating pipes to spread the heat across the entire floor rather than just where they meet the chipboard. The engineered wood floor should always be fully bonded to the chipboard for the best heat transference using the SW890 MS Polymer Adhesive.



Please call us to talk to one of our team so we can assist and ensure a trouble-free installation. 01666 504015 or email [info@thesolidwoodflooringcompany.com](mailto:info@thesolidwoodflooringcompany.com)



INDUSTRY  
PARTNER

